

PARKS DIVISION

15745 Lorene Drive
Victorville, CA 92392
760-955-5275

JOSHUA TREE INSPECTION PROCEDURES

Joshua trees on undeveloped land are protected by City Ordinance No. 1224. Grading a site, removing or damaging Joshua trees prior to completing the following procedures may result in fines and/or penalties for the property owner/developer.

APPLICATION PROCESS

1. Clearly mark all sites with survey stakes and a visible address.
2. Complete an application for Joshua Tree Review (copy attached).
3. Attach one set of site plans no larger than 24"x36" with a vicinity map that provides the inspector with clear directions to the subject property(s).
4. The site plan must indicate the location, diameter/caliper and height of each Joshua Tree located on the property and those that may be affected on any adjacent properties due to over excavation (sample attached).
5. The applicant must indicate the disposition of the trees (i.e., relocation on site, relocation to another property with that property owner's letter of authorization, or place the trees up for adoption). An adoption process may take 60 to 90 days and requires the completion and signature of an owner's permission letter allowing access to the property. ***The developer/owner is responsible for all associated advertising costs for public notification of tree availability.***
6. Once you have received a completed inspection report, you may then contact the Building and Safety Department for a grading permit. ***You must bring a copy of the completed Joshua Tree Inspection with you.*** The grading permit will be issued only when all appropriate paperwork is provided. **No grading** is to occur until the permit has been issued.

ADDITIONAL INFORMATION

A professional tree mover must relocate those trees larger than 8' in height and 6" in diameter. Joshua Tree background and transplanting information is available upon request. County requirements may apply to trees offered for sale, removed by a professional tree mover, or if the tree will be relocated outside of the City of Victorville. For more information, contact the San Bernardino County Agricultural Department at 14477 Amargosa Road, Victorville, Suite 1, or by calling 760-843-2770 or 800-734-9459.

For further information regarding Joshua Tree procedures, policies, etc., contact the Parks Division office at 760-955-5275.

VICTORVILLE COMMUNITY SERVICES DEPARTMENT
APPLICATION FOR JOSHUA TREE INSPECTION

FILE # _____ DATE _____

APPLICANT NAME _____ PHONE _____

APPLICANT ADDRESS _____ EMAIL _____

MAIL INSPECTION TO _____

AGENT FOR APPLICANT _____ PHONE _____

SITE ADDRESS _____

TRACT # _____ APN # _____ # OF TREES _____

PROPOSED DISPOSITION OF ANY JOSHUA TREES:

ARE PROPERTY BOUNDARIES CLEARLY MARKED WITH SURVEY STAKES? CIRCLE ANSWER YES NO

NOTE: This form may be photocopied for additional properties.

FOR DEPARTMENT USE ONLY

INSPECTION REPORT								DATE: _____			
NUMBER	HEIGHT	CALIPER	DISPOSITION	NUMBER	HEIGHT	CALIPER	DISPOSITION	NUMBER	HEIGHT	CALIPER	DISPOSITION
1				21				41			
2				22				42			
3				23				43			
4				24				44			
5				25				45			
6				26				46			
7				27				47			
8				28				48			
9				29				49			
10				30				50			
11				31				51			
12				32				52			
13				33				53			
14				34				54			
15				35				55			
16				36				56			
17				37				57			
18				38				58			
19				39				59			
20				40				60			

COMMENTS _____

INSPECTOR'S SIGNATURE _____

SAMPLE

Joshua Tree Site Plan

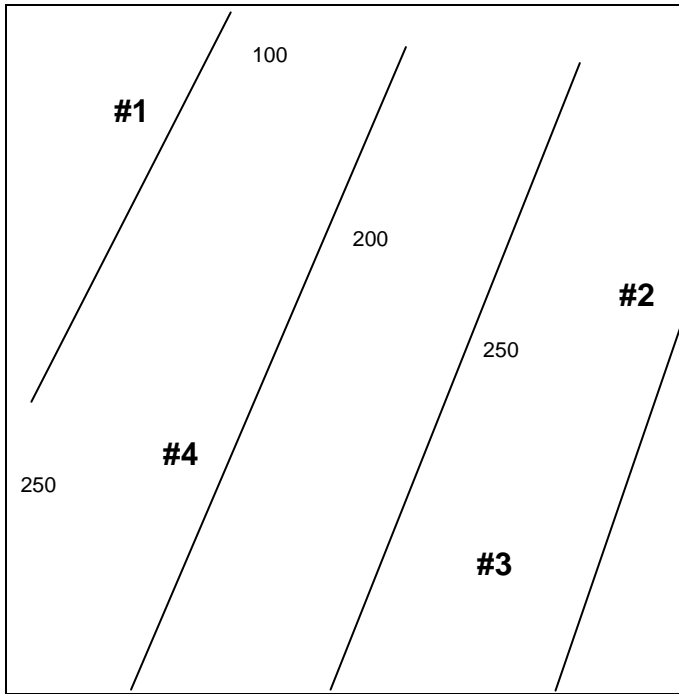

JOSHUA TREE #	HEIGHT	CALIPER
1	4'	4"
2	6'	4"
3	7'	5"
4	10'	7"



VICINITY MAP

Indicate major streets and cross streets or any other pertinent information that will assist the inspector in locating the subject property(s).

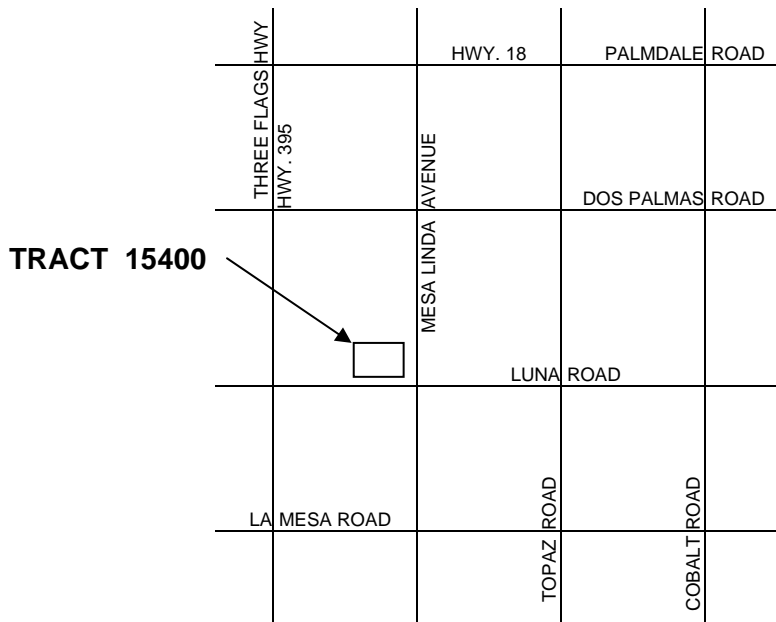

VICINITY MAP

NOT TO SCALE